

*ST. THOMAS MORE CATHOLIC  
VOLUNTARY AIDED PRIMARY SCHOOL  
DIOCESE OF NORTHAMPTON*



*NORTHAMPTON ROAD*

*KETTERING*

*NORTHANTS NN15 7JZ*

*TEL: (01536) 512112*

*E-Mail: [head@stthomasmore.northants-ecl.gov.uk](mailto:head@stthomasmore.northants-ecl.gov.uk)*

*Acting Headteacher: Mrs. Everington, Cert. Ed. Dip. Ed.*

*Dear Parent,*

*Welcome to St. Thomas More School and its prospectus. I hope you find the prospectus informative and user - friendly.*

*Our school aims to be vibrant, happy, popular and successful. High standards are expected in both classroom work and behaviour.*

*Gospel teaching forms the foundation of our school life. Love, patience, courage and consideration should shine forth.*

*Partnership and working together are the keys for the continuing success of our school.*

*Only with your help and support can we grow from strength to strength.*

*Your assistance is welcomed in the classrooms and with the Parents' Social Committee.*

*You are warmly encouraged to attend our assemblies and celebrations.*

*Parents have high expectations of our school and rightly so. We also have high expectations of you. Regular and punctual attendance are vital to your child's education.*

*Holidays during term time should be avoided. Reading, the foundation of an excellent education, should be encouraged at home.*

*I hope you enjoy reading this prospectus.*

*If I can be of further assistance please do not hesitate to contact me.*

*Yours sincerely,*

*Mrs M Everington*

*Acting Headteacher.*

## Guide to Our School Prospectus

1. Location and Layout of the School.
2. Mission Statement and Aims.
3. Governing Body.
4. School Staff
5. School Hours and Term Dates.
6. Absence and Illness; the School Curriculum.
7. R.E., English, Mathematics, Science, Information Technology.
8. History, Geography, Music, Design Technology, Art.
9. P.E., Sex Education, Health Education, Assessment and Testing.
10. How will my child be taught? Special Needs, Pupils with Disabilities, Homework, Extra Curricular activities.
11. Reporting to parents, School Profile, Complaints Procedure, Child Protection, Access to information, Charging Policy. School lunch, Safety.
12. School lunch, Safety, Discipline, School Rules, Separated Parents.
13. Secondary School Links, the Parents Social Committee, School Uniform, JD's Breakfast Club.
14. Year 2 and Year 6 Test Results

# 1. LOCATION & LAYOUT OF SCHOOL

The School is located on Northampton Road, just off Junction 8 of the A14.

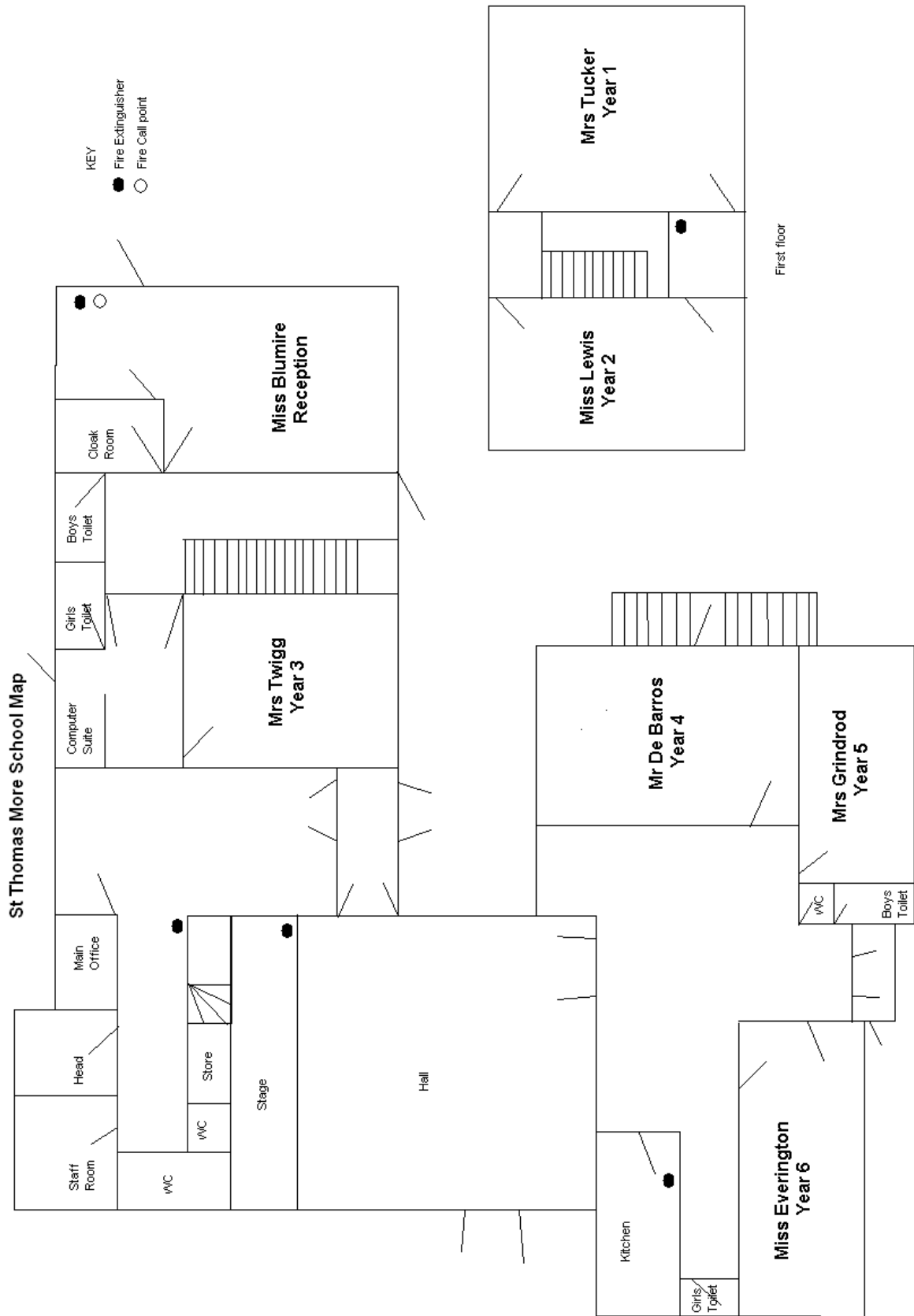

## 2. ST. THOMAS MORE CATHOLIC PRIMARY SCHOOL

### MISSION STATEMENT

‘Try to be like Jesus in all that we think do and say.’

#### The School Aims

##### Potential

To offer to each of our children, in every experience they meet at school, the highest quality of learning, values and understanding, enabling them to reach their full potential.

##### Dignity

To develop and cherish in all those working for our school, a sense of their own and others’ dignity; to nurture the example of Christ-like relationships which support and sustain us.

##### Faith

That our worship of God be expressed in joyful and prayerful liturgy, which celebrates the faith which we share and seek to deepen together.

##### Community

To ensure that the school portrays a lively and welcoming atmosphere, involving home and parish so that children can learn to relate to one another and to the wider community.

### JESUS SAID ‘LET THE LITTLE CHILDREN COME TO ME...’

All our children, Catholic and non-catholic, from whatever background, become one family in our school. No distinction is made between them except in the final preparation for the Sacraments of the Catholic church. All are expected to uphold the same values and conduct in the tradition of the school and develop respect for other religious beliefs.

### 3. THE GOVERNING BODY

CHAIRPERSON OF GOVERNORS: Mr. W. Falshaw [Foundation Governor]

VICE-CHAIRPERSON OF GOVERNORS: Mrs. A. Fletton (Foundation Governor)

FOUNDATION GOVERNORS: Father. A. Richardson  
Mrs. M. Tailby  
Mr. S. Cumiskey  
Mrs. A. Evans  
Mrs. C. Ringrose  
Mr. E. Gilbey

ASSOCIATE MEMBER Councillor. T. Freer  
Mrs. J. Walsh

LOCAL AUTHORITY GOVERNOR: Mr. C. Best

SPONSOR GOVERNORS: Mr. J. Marriott

STAFF GOVERNORS: Mrs. M. Everington  
Miss. C. Lewis  
Mrs. D. Bulley

PARENT GOVERNOR: Mr. P. Gilhooly

CLERK TO THE GOVERNORS: Mrs. S. Colley

All correspondence addressed to the Chair of Governors, c/o the School, will be treated in strict confidence.

## 4. SCHOOL STAFF

### THE SCHOOL CHAPLAIN:

The School Chaplain, Father Andy Richardson, keeps in close contact with the pupils and staff. He plays a full part in the school, leading and sharing with staff and pupils in the celebration of the Liturgy.

The Chaplaincy plays a vital role in the care of pupils, offering support to all our families whenever needed.

### TEACHING STAFF:

Mrs. M. Everington	Acting Headteacher,
Miss. N. Everington	Year 6 Teacher/Senior Acting Assistant Headteacher
Mrs. E. Grindrod	Year 5 Teacher
Mr. J. de Barros	Year 4 Teacher
Mrs. A. Twigg	Year 3 Teacher
Miss. C. Lewis	Year 2 Teacher
Mrs. M. Tucker	Year 1 Teacher
Miss. S. Blumire	Reception Teacher/Acting Assistant Headteacher
Mrs. S. Harris	Teacher of Booster Classes and PPA

### SECRETARIAL & SUPPORT STAFF:

Mrs. S. Colley	Bursar
Mrs. D. Blumire	Office Support staff
Mrs. C. Andriosuk	Teaching Assistant
Mrs. F. Thomas	Teaching Assistant
Mrs. V. Montgomery	Teaching Assistant
Mrs. A. Machell	Teaching Assistant
Mrs. D. Bulley	Teaching Assistant
Mrs. M. Loasby-Childs	Teaching Assistant
Mr. P. Murphy	Teaching Assistant
Mrs. C. Roberts	Special Needs Teaching Assistant
Mrs. M. McCarney	Special Needs Teaching Assistant
Mrs. J. Burke	Special Needs Teaching Assistant
Mrs. J. Walsh	Special Needs Teaching Assistant
Mrs. S. Fawkes	Special Needs Teaching Assistant
Mrs. A. Millar	Special Needs Teaching Assistant

### DINNER SUPERVISORS:

Mrs. G. Pepper	Mrs. J. Sansone	Mrs. A. Di Renzo
Mrs. C. Di Fazio	Mrs. I. De Jesus	Mrs. A. Fletcher
Mrs. N. Wijesinghe		

### CLEANING & CARETAKING STAFF:

Mr. I. Bell	Mrs. H. Jervis	Mrs. A. Glentworth
-------------	----------------	--------------------

## 5. THE SCHOOL DAY

### School Times

8:50 am	School starts
12:00 pm - 1:15 pm	Infant lunch
12:15 pm – 1:15 pm	Junior lunch
3:15 pm	School ends

### School Term Dates September 2011 – July 2012

Autumn Half Term	Close Re-open to pupils	Friday Tuesday	21 <sup>st</sup> October 1 <sup>st</sup> November
Christmas	Close Re-open to pupils	Friday Wednesday	16 <sup>th</sup> December 4 <sup>th</sup> January 2012
Spring Half Term	Close Re-open to pupils	Friday Monday	10 <sup>th</sup> February 20 <sup>th</sup> February
Easter Holiday	Close Re-open to pupils	Friday Tuesday	30 <sup>th</sup> March 17 <sup>th</sup> April
May Bank Holiday	School Closed for the day	Monday	7 <sup>th</sup> May
Summer Half Term	Close Re-open to pupils	Friday Monday	1 <sup>st</sup> June 11 <sup>th</sup> June
Summer 2012	Close	Friday	20 <sup>th</sup> July

## 6. ABSENCE AND ILLNESS PROCEDURES

Parents should contact the Headteacher if they wish to keep a child off school due to reasons other than illness and/or medical treatment.

Following a letter from the County Council in which the Government's viewpoint is stated, '**holidays in term time are detrimental to a pupil's education**' the Governing Body has decided that leave of absence will only be granted for **compassionate reasons**. Consequently the vast majority of holidays during term time will no longer be authorised. Absences will be marked as unauthorised in the register if parents take children on holiday during term time. Parents are advised that the absence may bring the pupil's attendance to a level that meets the threshold for concern and may result in a request for the involvement of the Education Welfare Service. All schools in the County are expected to follow the County policy.

Letters are required to explain absences where it has not been possible to obtain prior permissions, e.g. illness/medical treatment. Unexplained absences and lateness are recorded in the registers and are reported. This issue is treated very seriously as absence affects school performance.

## THE SCHOOL CURRICULUM

Particular attention is given to:

- Clear progression in mathematics, including number, shape, measuring and data handling
- Thorough teaching of reading skills for enjoyment and understanding
- Careful observation and measuring in science
- Developing children's confidence, creativity, independence and sense of responsibility.

Our school follows the National Curriculum which consists of:

English	History	Design Technology
Maths	Geography	Art
Science	Music	P.E.
Information Technology		

In addition your child learns about:

Christian Faith and Morality in a Catholic context.

The importance of concentration, application, group & team work for effective and happy progress.

Presenting and valuing their own work.

Safety, hygiene, healthy living, citizenship and personal relationships.

Our school places a great deal of emphasis on the basics. Without a solid foundation in the areas of numeracy and literacy the pupils will not reach their full potential.

The arts are not neglected in our school. The arts are an essential part of human life. With this in mind we have at least one visit per term by a touring theatre or music group. These visits stimulate a good deal of interest and follow up work. Artistic activities form part of many areas of the curriculum.

## 7. RELIGIOUS EDUCATION

Religious Education is much more than a taught subject i.e. a scheme of work or a syllabus. The focus of our lives in school is the Gospel message and celebration of the Liturgy. Christ is at centre of all we do. Through religious education we try to develop a spiritual and moral set of values that will enable the children to grow and develop as responsible Christians. Prayer is an important part of our daily lives and we encourage the children to develop their own prayers in order that they build up a loving relationship with God our Father.

We use the, 'Here I Am', religious education scheme.

## ENGLISH

We encourage pupils to be confident and articulate using speech, writing and reading to the best of their ability so that they are able to communicate showing an awareness of the thoughts and feelings of others.

As part of their learning children will have opportunities for talking and listening to pupils, teachers, parents, and other adults in a variety of situations.

Children will acquire a style of writing which will show due regard for spelling, grammar and punctuation. There will be opportunities for children to publish their own work using a word processor.

Children's creativity and imagination will be encouraged and developed.

Children will develop and extend those reading skills and experiences which have been acquired prior to starting school so that they become skilled readers. The importance of reading for pleasure will be given special emphasis. As children progress through the school they will be expected to read widely for information.

## MATHEMATICS

Mathematics provides a means of communication through symbols, data, algebraic expressions, graphs and tables.

Practical work precedes the recording of results so that children can begin to understand the application of mathematics to real life situations.

The practical approach helps children to enjoy working with numbers. We therefore encourage children to play mathematical games, children make the most progress when they are successful and confident.

Number, algebra, measurement, shape and space form the basis for the maths curriculum. Children will be expected to solve problems and provide logical explanations for their solutions. This will enable children to apply relevant number bonds and develop mental agility.

Children will be taught to recognise and construct regular shapes in two and three dimensions. Children will be taught to present and interpret simple numerical data in either table or graph form.

## SCIENCE

We aim to provide a curriculum which encourages children to adopt a scientific approach to learning and to acquire the skills of observation, recording, forming hypotheses, testing, investigating and forming conclusions in their explorations of natural and man-made environments.

The children will be helped to understand that scientific experimentation is often a matter for co-operation within a team and for checking and taking forward an idea already worked at by others.

## INFORMATION TECHNOLOGY

We aim to give the children opportunities to store, process and present information by electronic means to enhance and extend their learning.

We fully intend to keep up-to-date with developments in this area.

Time will be given to the building up of critical and practical skills in order that an appreciation of art can take place.

Children will acquire the language of art as part of their artistic and linguistic development.

Art work will be used to supplement much of the work that takes place in other areas of the curriculum.

## 8. HISTORY

A knowledge and understanding of the past can help children make sense of the present. History reinforces a sense of curiosity, the love of story and an appreciation of adventure and travel.

In order to discover their past the children will develop research skills and read widely. Chronological conventions form an important part of teaching history.

## GEOGRAPHY

We aim to extend and develop the children's learning from their immediate environment to more distant places and peoples.

The children will present their learning using models, maps, pictures, globes, diagrams, graphs and writing.

The development of research skills is crucial.

## MUSIC

Our lessons enable children to derive pleasure and fulfilment from music.

The children will learn and participate in singing a range of songs.

Children will have opportunities to compose their own music.

Children will be introduced to the works of major composers.

As children mature and become more skilled they should develop a growing awareness of the various elements of music including pitch, rhythm and harmony.

Children can receive tuition in the following instruments - violin, guitar, flute, clarinet and some brass instruments.

## DESIGN TECHNOLOGY

Technology allows the imaginative and creative capabilities of children to flourish. In line with the National Curriculum requirements, children's designs are brought to life using a variety of materials including card, wood and manufactured construction kits.

## ART

Art enables children to express ideas, inner feelings or emotions through a range of media. Art enables children to become visually and aesthetically aware.

Through a systematic programme of work children will develop a perception of colour, line, shape, form, texture, tone and pattern.

Time will be given to the building up of critical and practical skills in order that an appreciation of art can take place.

Children will acquire the language of art as part of their artistic and linguistic development.

Art work will be used to supplement much of the work that takes place in other areas of the curriculum.

## 9. PHYSICAL EDUCATION

P.E. includes games, athletics, outdoor activities, gymnastics, dance, and swimming.

The children in years 5 and 6 receive swimming lessons for part of the year.

It is expected that all children will change into red shorts and white T-shirt for P.E.

If a child is unable to do P.E. an explanatory letter should be sent to the school.

As a school we aim to provide a variety of sporting activities which promotes good health, co-operation, positive competition, enjoyment, sportsmanship and individual fulfilment.

After school clubs include netball, athletics, games, football and cricket.

We have a weekly basketball breakfast club.

Y5 and Y6 children take part in additional outdoor and adventurous activities during their residential visits.

The school is fortunate in having a large hall, extensive playing fields and equipment for sport.

## SEX EDUCATION

The children's sex education is based on Christian principles. Sex education is geared to the child's stage of development. It does not concentrate solely on basic facts but allows the children to develop a growing awareness of themselves and their relationships with others.

In the 10+ age group we teach the children about the physiological changes in boys and girls at the onset of puberty, the anatomy of the male and female reproductive systems and the process of conception.

The Northamptonshire Area Health Authority advises and assists in the sex education provided. Parents have the right to withdraw their child from these lessons. A parents'

evening is organised during the Spring term where more information is given concerning sex education.

## HEALTH EDUCATION

We aim to give children an awareness of the need to care for their own bodies through diet, healthy personal habits and through an awareness of the causes of sickness and health. We also aim to teach them to apply the knowledge and skills of safety education at home, at play, on the roads as well as at school.

## ASSESSMENT AND TESTING

Your child's progress is continually monitored by the class teacher. Teachers carry out a more formal assessment on each child every term.

National standardised tests are taken in Maths and English at the end of the infant years. National tests are taken in Maths, English and Science at the end of the junior years. Standardised tests in Maths and English are taken by the pupils in Y3, Y4 and Y5 in the Summer term.

Children differ from one another. Therefore, the purpose of these results is not to compare one child with another. Rather, it is to recognise achievement and to identify and support needs.

## 10. HOW WILL MY CHILD BE TAUGHT?

First of all, it is essential that your child is happy and secure in the classroom. Any factor which seriously hampers that should be carefully discussed with the class teacher.

In every class each activity is planned with a clear purpose, usually as an element of the National Curriculum.

Work is organised on an individual, group or class basis to take account of children's differing talents, needs and understanding and the learning activity.

## SPECIAL NEEDS

The Special Needs policy of the school is well-developed and active, enabling children to gain confidence and make progress. The policy is available from the school. A reference copy is kept outside the office. Any parent who has concerns about their child should consult the class teacher. If necessary the teacher will consult with the Special Needs Co-ordinator. The co-ordinator presents an annual report to the Governing Body.

## PUPILS WITH DISABILITIES

Steps are taken to prevent disabled pupils being treated less favourably than other pupils. (Please see the Governors' policy on equality). The admissions policy applies to all children irrespective of gender, background, disabilities etc.

All pupils participate in everyday activities as far as they are able.

Access for the disabled forms an important part of the new extension (2003). The extension includes a toilet for the disabled as well as an accessible entrance.

## HOMEWORK

Class teachers set homework: for instance reading, research at the local library or completion of a set task. It is expected that children will continue learning spellings and multiplication tables at home. Reading books are taken home frequently. Please see the homework policy.

## EXTRA CURRICULAR ACTIVITIES

A wide range of activities are available to the children during, before and after school including:

- Football (Y1 to Y6)
- Choir
- Drama (Juniors)
- Games (Juniors)
- Design and Card Making (Juniors)
- Music orchestra (Juniors)
- Basketball (Juniors)
- Netball [Juniors]
- Athletics
- Cricket (Y5 & Y6)
- Sewing

Parents are asked to give their consent to their child staying for any after school club.

Transport home is the parent's responsibility but no child is left unattended until a responsible adult meets the child.

An after-school club runs every school day from hometime to 5.25pm. A charge is levied for this. If interested please telephone Mrs. Dove for further details, (01536) 513084.

**COPIES OF ALL THE SCHOOL'S POLICIES ARE AVAILABLE FOR REFERENCE IN A FILE BY THE SCHOOL OFFICE**

## 11. REPORTING TO PARENTS

We organise two parents' evenings per year which give you an opportunity to discuss your child's progress.

A written report on your child's progress is sent home in July.

Curriculum evenings are organised to inform parents about developments in education.

## SCHOOL PROFILE

This can be accessed on the web at <http://schoolprofile.parentscentre.gov.uk>

## COMPLAINTS PROCEDURE

The school follows the L.E.A. procedures.

## CHILD PROTECTION ACT

It may be helpful for parents to know that the Authority requires Headteachers to report any obvious or suspected case of child abuse which includes non-accidental injury, severe physical neglect, emotional abuse and/or sexual abuse.

This procedure is intended to protect children at risk and schools are encouraged to take the attitude that where there are grounds for suspicion it is better to be safe than sorry. This does mean that Headteachers risk upsetting some parents by reporting a case which, on investigation, proves unfounded. In such circumstances, it is hoped that parents, appreciating how difficult it is for Headteachers to carry out this delicate responsibility, would accept that the Headteacher was acting in what were believed to be the child's best interests.

## ACCESS TO INFORMATION

You are entitled to see your child's written educational records. Advance notice is required. Please contact the Headteacher.

## CHARGING POLICY

No charges are made for any school activity, except for individual music tuition where parents choose that for their child. Parents will, however, be invited to make voluntary contributions to assist with the cost of school trips.

## 12. SCHOOL LUNCH

All children are required to bring a packed lunch to school as there are no hot meals provided by the local authority.

### SAFETY

We accept responsibility for administering prescribed medicines during the school day provided there is written parental authority. Medicines must be kept in the dispensed container with the child's name. Children are not allowed to carry medicines with them except for inhalers.

In the event of a serious accident during the day parents will be informed immediately and the necessary treatment provided. Occasionally, in the interests of safety, a visit to the local surgery or hospital may be necessary.

It is important that we are aware of any allergies or medical information that would be vital in those circumstances. Please keep us up to date with any changes in address and telephone number.

### DISCIPLINE

We want our children to be happy, safe, confident, caring and thoughtful of others.

However we are not perfect all the time. So how do we deal with problems?

Firstly any problem which arises in the classroom is dealt with by the class teacher.

Problems at playtime are dealt with by the teacher on duty or by the lunchtime supervisors, who may call upon senior staff if necessary.

More serious and frequent misbehaviour such as bullying will be dealt with by the headteacher. Dialogue with parents is essential.

We have high expectations of conduct and effort in normal circumstances. Children, under stress, often exhibit behavioural problems. We can help and understand the child's misbehaviour if we are informed of any problems at home. Please keep in touch with us - confidentiality will be respected.

Positive behaviour is strongly encouraged throughout the school. Praise is used to support good behaviour.

### SCHOOL RULES

1. Always be polite and look after your belongings and your school.
2. Stealing, being unkind and hurting other children are not allowed. We will have to tell your parents.

3. Walk around the school quietly. Do not push shout or run indoors.
4. Never stay in the classroom without a teacher or other grown-up.
5. Always do as you are told by teachers, dinner ladies and grown-ups who work in our school.

### SEPARATED PARENTS

Both natural parents and those with parental responsibility, under the 1991 Children's Act, are entitled to receive information from school about their child, school reports, notification of parents' evenings and the governors' annual report are sent automatically. Please advise the school of any change of circumstances.

### 13. CATHOLIC SCHOOLS SERVING OUR CHILDREN

The Governors encourage parents to consider sending their child to Thomas Becket Secondary Catholic School in Northampton. A bus service is available from Kettering. Further details can be obtained from the school, telephone (01604) 493211.

### THE PARENTS SOCIAL COMMITTEE

The committee cares for the education and welfare of all our children.

It raises money to provide valuable extras, organises events and activities for the children and arranges great social functions for parents and friends.

It runs Christmas and summer fayres, sponsored walks, fun days, picnics, children's discos, fashion shows, dances and many other events.

The success of the Social Committee relies upon the attendance and support of the parents, families and friends. Please support us.



## SCHOOL UNIFORM

By wearing school uniform children feel a sense of belonging and have pride in their school.

All clothing, shoes, bags etc., should be labelled with your child's name. Shower proof fleece jacket (with concealed hood)/Pink checked blouses/Sweatshirts/Polo shirt/P.E. kit/Book/P.E. bags/Baseball cap - available from school.

**Girls:** Grey pinafore dress/skirt

Pink checked blouse

Pink checked summer dress

Red school sweatshirt with logo

Plain grey, black or white socks/tights

Optional grey or black trousers (fitted waist, straight leg)

**Boys:** Grey or black trousers or shorts

Red school sweatshirt with logo

Red polo shirt with collar and logo [the logo is optional

Parents are welcome to purchase plain red polo shirts locally

Plain grey or black socks

**All Children:** Black or brown outdoor shoes

A change of footwear for indoors

Junior children require trainers for outdoor games

**P.E. Kit:** White tee-shirt with logo

Red shorts

Parents are free to purchase a plain white tee-shirt and red shorts from the shops

**Shoe Bags:** Clearly marked on the outside.

**Jewellery:** The wearing of jewellery is prohibited on health and safety grounds. Ear studs can be worn but the child must be capable of taking them out and putting them back in for the purposes of P.E.

# JD's Breakfast Club

Operating at St. Thomas More Catholic School, Kettering

A section of JJ's After School Club  
OFSTED Registration Number EY305282

## Club Information

JD's Breakfast Club offers before school care to pupils of St. Thomas More Catholic Primary School, Kettering.

We are pleased to work on cooperation with the School.

The Club is managed and run by Jill Dove with assistance from Shirley Ball.  
We operate with at least 1 adult per 8 children.

We meet in the school buildings every day of term between 7:50 am and 8:45 am  
Breakfast is served from 8:00 am onwards and includes:

A hot drink (tea, coffee, cocoa) or squash  
Toast and butter with various spreads  
Bacon rolls  
Fruit

A range of activities is offered including:  
A small range of crafts  
A variety of toys  
A number of play resources  
Free play

We can also accommodate those who want to do homework  
(but don't guarantee grades if we are asked for help!)

Our fees are £3:00 per session including craft materials and food  
Cheques payable to 'JD's Breakfast Club'

We have a full set of policies and procedures which we are pleased to show to parents if they wish to see them

We aim to provide the care you want for your children and welcome your comments

In case we fail, our complaints procedure is on the reverse of this sheet

Attached you will find our application and consent form

We look forward to seeing you and your child.

Managing Partner Jill Dove

Contact Address 28 Hall Lane, Kettering, NN15 7LJ. Home Tel: (01536) 513084

There is also an After School Club which is run on site during term time by Jill Dove and Janice Thorpe.

14.

## YEAR 6 SUMMARY REPORT

These tables show a summary of the National Curriculum results of pupils in the school (2009) as a percentage of those eligible for assessment

The number of eligible children is: 32

Results of Teacher Assessment 2009										
	Percentage at each level									
	W	1	2	3	4	5	6	Pupils disapplied	Pupils absent	
English	0	0	0	0	66	31	0	3	0	
Maths	0	0	0	16	56	25	0	3	0	
Science	0	0	0	0	50	47	0	3	0	

Figures may not total 100 per cent because of rounding

Test Results 2009						
	Percentage at each level					
	Below level 3*	3	4	5	Pupils not entered#	Pupils absent
English	0	0	72	25	0	0
Reading	0	0	41	56	0	0
Writing	0	16	63	19	0	0
Maths	0	16	56	25	0	0
Science	0	0	50	47	0	0

W represents pupils who are working towards level 1, but have not yet achieved the standards needed for level 1.

\* represents pupils who were not entered for the tests because they were working below level 3 in English, maths or science, pupils awarded a compensatory level from the tests, and pupils entered for but not achieving a level from the tests.

# represents pupils working at the levels of the tests, but unable to access them, formally referred to as disapplied.

## YEAR 2 COMPARATIVE REPORT

This table shows a summary of the National Curriculum assessment results of pupils in the school (2009) and nationally (2008) at the end of Key Stage 1, as a percentage of those eligible for assessment.

The number of eligible children is: 30

Figures may not total 100 per cent because of rounding.

RESULTS OF TEACHER ASSESSMENT										
Percentage at each level										
		W	1	2	2C	2B	2A	3 or above	Disapplied Children	Absent Children
Speaking & Listening	Boys	0	7	21				71	0	0
	Girls	0	0	31				69	0	0
	Whole School	0	3	27				70	0	0
	National	2	11	65				21	0	0
Reading	Boys	7	0		14	14	14	50	0	0
	Girls	0	0		0	13	6	81	0	0
	Whole School	3	0		7	13	10	67	0	0
	National	3	13		13	22	24	25	0	0
Writing	Boys	7	0		29	29	7	29	0	0
	Girls	0	0		19	19	13	50	0	0
	Whole School	3	0		23	23	10	40	0	0
	National	5	15		22	27	19	12	0	0
Mathematics	Boys	7	0		0	21	7	64	0	0
	Girls	0	0		0	19	19	63	0	0
	Whole School	3	0		0	20	13	63	0	0
	National	2	8		16	25	27	21	0	0
		<b>W</b>	<b>1</b>	<b>2</b>	<b>2C</b>	<b>2B</b>	<b>2A</b>	<b>3 or above</b>	<b>U</b>	
Science	Boys	7	0	29				64	0	
	Girls	0	0	25				75	0	
	Whole School	3	0	27				70	0	
	National	2	9	67				22		

**W** represents children who are working towards level 1, but have not yet achieved the standards needed for level 1.

**U** represents children for whom it is not possible to determine a level.